



YOSHIMURA

RESEARCH&DEVELOPMENT OF AMERICA, INC.

5420 DANIELS STREET STE A, CHINO CA., 91710 · (800) 634-9166 · (909) 628-4722 · FAX (909) 591-2198

www.yoshimura-rd.com

Signature Series

Qualified Manufacturer Declared "Replacement Part"

2007~2018

Honda CRF150R

2215503 (SS/AL)

RS-2 Stainless Steel Full-System



Signature Series systems are:

- CARB/EPA tail-pipe emissions compliant.
- Marked with appropriate EPA noise labels.
- Independent laboratory tested for EPA new vehicle noise compliance.

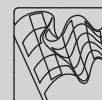

CAUTION: The muffler packing on this system **MUST** be replaced every 6-8 hours of use, or after each moto. Failure to follow recommended muffler re-packing interval can cause muffler damage and may void the warranty.



NOTE: IN THE STATE OF CALIFORNIA, IT IS ILLEGAL TO MODIFY THE EMISSION CONTROL SYSTEM, WHICH INCLUDES THE CARBURETORS OF ANY VEHICLE.

Caution: Exhaust system can be extremely hot. Let motorcycle cool down before beginning installation.

Note: Read through all instructions before beginning installation.

Tools Needed:

10mm and 12mm Sockets
Ratchet Wrench and Extension
5mm Allen Key
Torque Wrench
Spring Puller Tool

Installation Steps:

1. Remove right rear number plate (see Fig. 1 for bolt locations).
2. Remove stock exhaust system and stock exhaust port gasket (see Fig. 2 and 3 for nut and bolt locations).
3. Install new stock exhaust gasket (not supplied).
4. Install Yoshimura header using stock header nuts. Do not tighten header nuts at this time. Leaving the header nuts loose will allow you to adjust the header position if necessary for proper fitment of the exhaust system.
5. Remove stock heatshield from stock header and install stock heatshield onto Yoshimura header using stock hardware (see parts diagram on page four for details).
6. Install supplied rubber grommet into muffler mounting bracket. Insert aluminum insert into rubber grommet (ensure shoulder of insert faces toward the frame mount, see Fig. 4).
7. Install Yoshimura tailpipe and muffler onto Yoshimura header. Mount tailpipe to stock chassis mount location using the stock chassis mount bolt (leave loose).
8. Mount muffler to stock muffler mount location using supplied bolt and washer. Torque muffler mount bolt to 2.5 kg-m (18 lb-ft).



Fig. 1

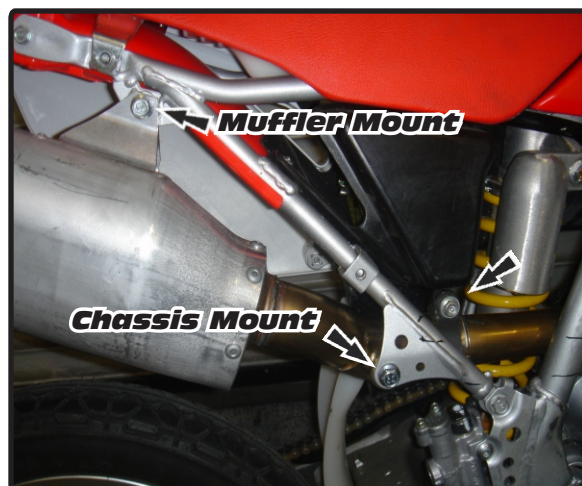

Fig. 2



Fig. 3

9. Torque stock header nuts to 1.25 kg-m (9 lb-ft).
10. Torque chassis mount bolt to 2.5 kg-m (18 lb-ft).
11. It is recommended that the muffler and tailpipe be wiped down with rubbing alcohol to remove oil and fingerprints. This will help prevent tarnishing of the finish after the exhaust is heated up.
12. Trim the number plate as shown in figure 5. The dotted line in figure 5 shows where the plastic must be cut.
13. Reinstall number plate.
14. Before starting motorcycle, check for proper clearance between new exhaust system and rear suspension (i.e. tire, swing-arm, brake, rear shock, etc). If any problem is found, please carefully follow through the installation steps again. If problem still persists, please call Yoshimura technical department at (800) 634-9166 / in CA (909) 628-4722.

NOTE: After starting motorcycle, it is normal for new exhaust system and muffler to emit smoke until oil residue burns off.

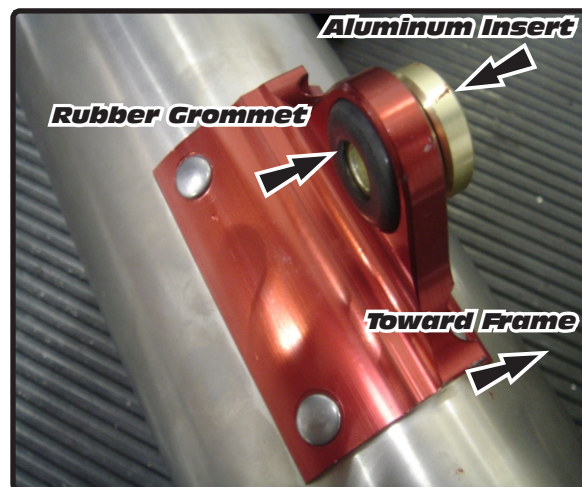
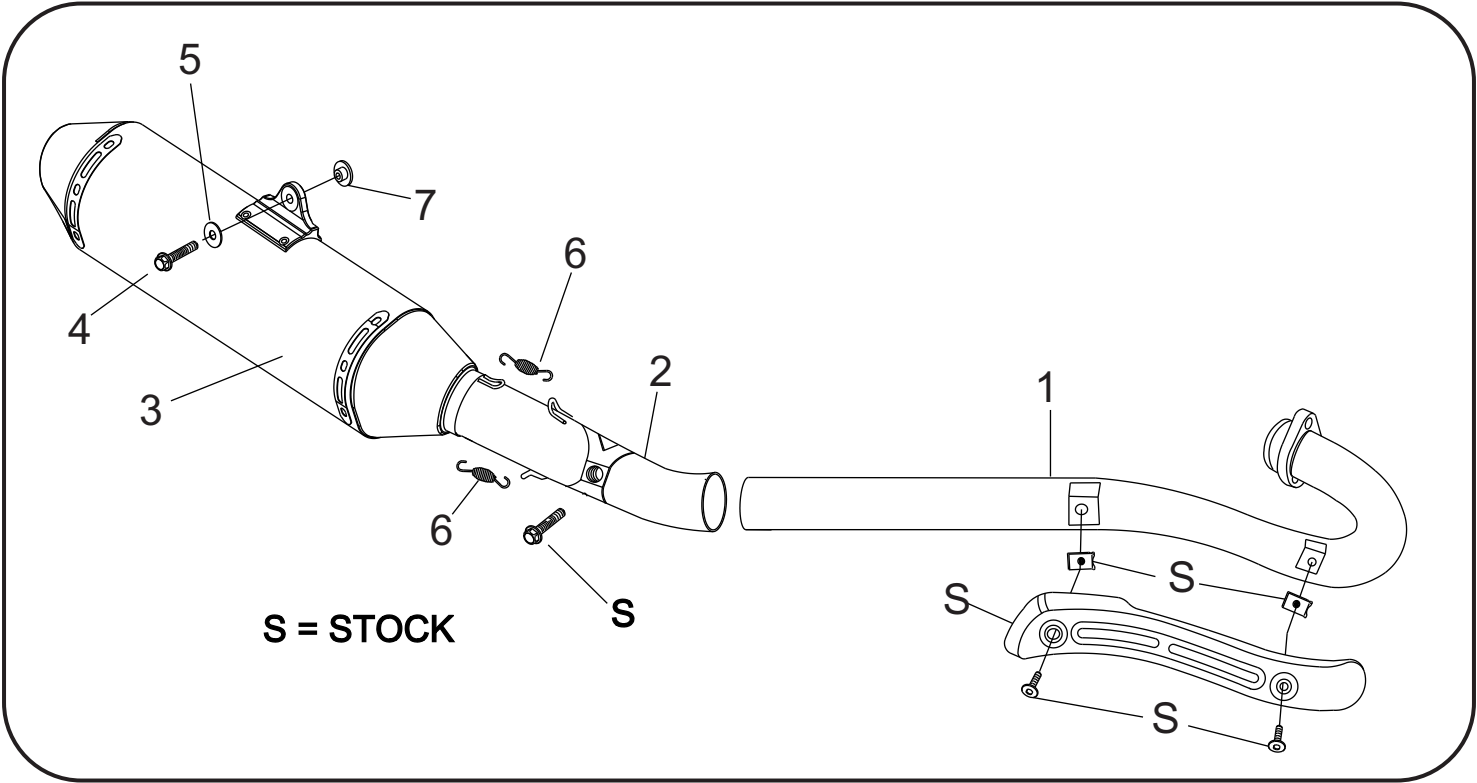

Fig. 4



Fig. 5

#2215503



Parts Diagram

NO.	DESCRIPTION	QTY	PART #
1	Yoshimura Stainless Steel Header	1	2215-101
2	Yoshimura Stainless Steel Tailpipe	1	2215-144
3	Yoshimura Race Muffler with Aluminum Sleeve	1	2215503-RMA
4	8mm X 40mm Flange Bolt	1	M8X40H
5	8mm Large Washer	1	8MMWASHERL
6	Small Exhaust Spring	2	RACE-SPX-1
7	Aluminum Insert for Rubber Bushing	1	ALS-002
**	Rubber bushing	1	Z1022
**	Spring Puller Tool	1	ST-200
**	Yoshimura Vinyl Sticker	2	17028-BLK

Nuts and Bolts Guide (Actual Size):

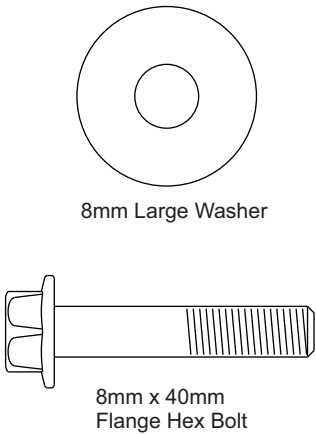



YOSHIMURA

RESEARCH&DEVELOPMENT OF AMERICA, INC.

5420 DANIELS STREET SUITE A, CHINO, CA 91710 · (800)634-9166 · (909)628-4722 · FACSIMILE (909)591-2198

www.yoshimura-rd.com

Spark Arrester Cleaning Information

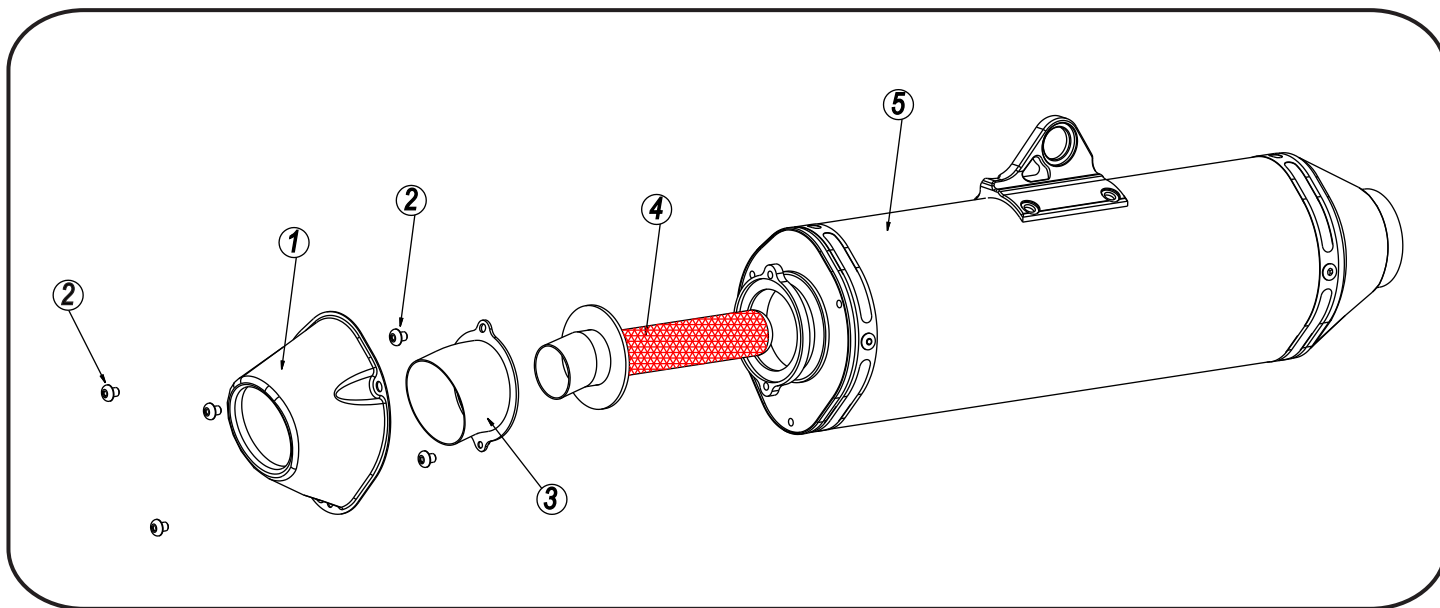

Parts Diagram

Caution: *Muffler can be extremely hot. Let muffler cool down before removing spark arrester.*

Note: *Read through all instructions before beginning disassembly.*

NO.	DESCRIPTION	QTY
1	Cone Cap	1
2	5mm x 10mm Button Head Bolt	5
3	Exhaust Tip	1
4	Spark Arrester	1
5	Muffler Assembly	1

Tools Needed:

3mm Allen Key
Wire Brush
Pair of Gloves
Safety Glasses

Cleaning Steps:

- 1 Using a 3mm Allen key, remove the three 5mm x 10mm button head bolts that secure the cone cap to the muffler (see Parts Diagram for location).
- 2 Remove the two 5mm x 10mm button head bolts that secure the spark arrester to the muffler. Remove the spark arrester from the muffler.

- 3 Using a wire brush, remove carbon deposits from spark arrester screen. Inspect the screen for excessive wear or damage. If spark arrester is excessively worn or damaged, the spark arrester must be replaced. Cleaning and inspection should be performed after every 60 hours of use.

CAUTION: *Gloves and Safety Glasses should be worn while cleaning spark arrester.*

- 4 Re-install spark arrester and cone cap. Torque the 5mm x 10mm bolts to 1.0 kg-m (7.3 lb-ft).

NOTE: *It is recommended that a low strength "Loc-tite" is used on the 5mm x 10mm bolts.*