



YOSHIMURA

RESEARCH & DEVELOPMENT OF AMERICA, INC.

5420 DANIELS STREET STE A, CHINO CA., 91786 · (800)634-9166 · (909)628-4722 · FACSIMILE (909)591-2198

www.yoshimura-rd.com

RS-3 OVAL PERFORMANCE EXHAUST SYSTEM

**SUZUKI
'98-01
TL1000R**

TL118SOC

ZYCLONE BOLT-ON SYSTEM

TL11950

RACE ONLY BOLT-ON SYSTEM

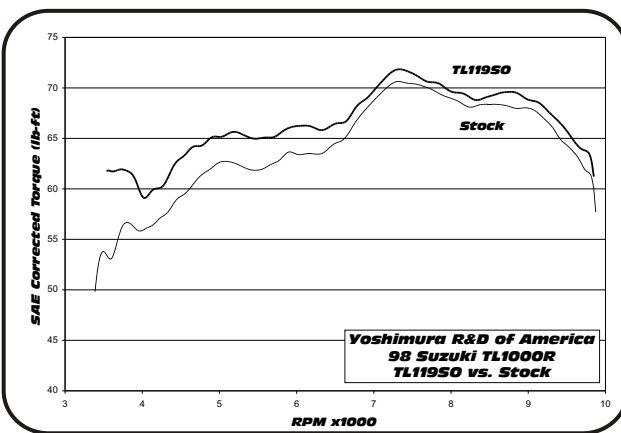
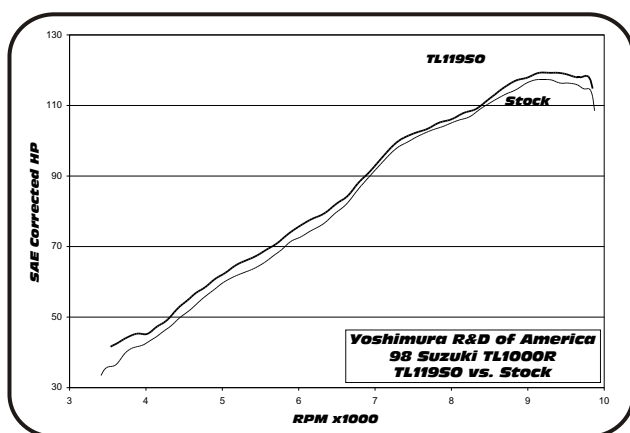

Note: Dynographs are for comparison use only. Actual results may vary depending on operating and motorcycle condition.



**THIS PRODUCT IS DESIGNED FOR USE IN CLOSED COURSE
RACING AND IS NOT INTENDED FOR HIGHWAY USE.**



NOTE: IN THE STATE OF CALIFORNIA, IT IS ILLEGAL TO MODIFY THE EMISSION CONTROL SYSTEM, WHICH INCLUDES THE CARBURETOR, OF ANY VEHICLE.

Caution: Exhaust system can be extremely hot. Let motorcycle cool down before beginning installation.

Note: Read through all instructions before beginning installation.

Tools Needed:

12mm socket
3/8" ratchet
12mm and 14mm wrenches
Torque wrench

Installation Steps:

- 1 Remove stock mufflers and muffler gaskets.
- 2 Install new muffler gaskets.
(Not supplied - Suzuki part no. 14181-02F00)
- 3 Install Yoshimura mufflers using supplied bolts.
Torque bolts to 2.3 kg-m (16.5 lb-ft).
- 4 Apply heat resistant tape to inside of muffler clamps and slide clamps onto mufflers.
(note direction of clamp in Fig. 1&2)
- 5 Mount clamps to stock muffler brackets using stock bolts, washers, and nuts. (see Fig. 1&2)
Torque bolt to 2.5 kg-m (18 lb-ft).
- 6 Check for proper clearance between new muffler and motorcycle. (i.e. swing-arm, passenger foot-peg, rear wheel, etc.) If any problem is found, please carefully follow through the installation steps again. If problem still persists, please call Yoshimura tech. Dept. at (800)634-9166 / in CA (909)628-4722

Note: After starting motorcycle, it is normal for new exhaust system to smoke until oil residue burns off.

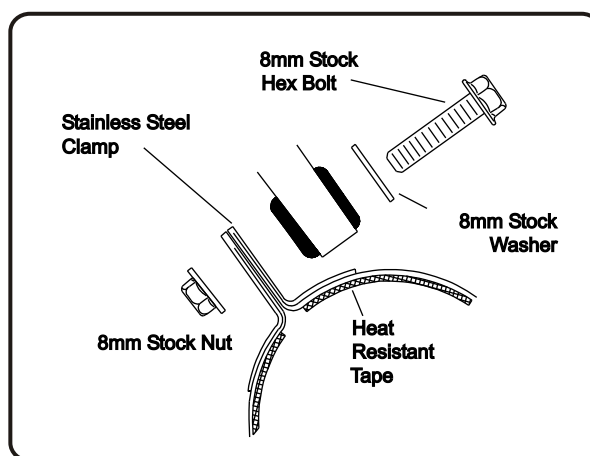

Right Side

Fig. 1

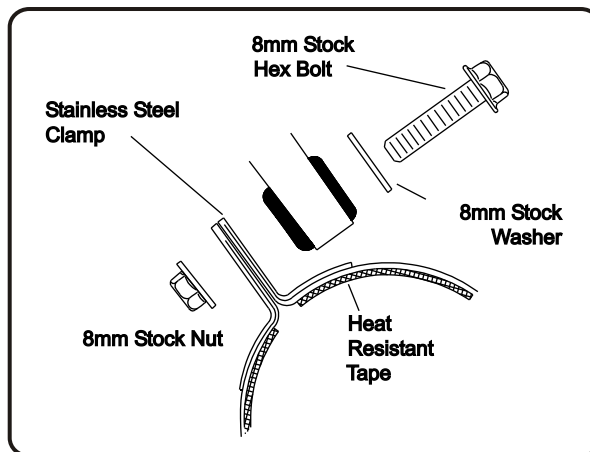

Left Side

Fig. 2

#TL118SOC/TL119SO

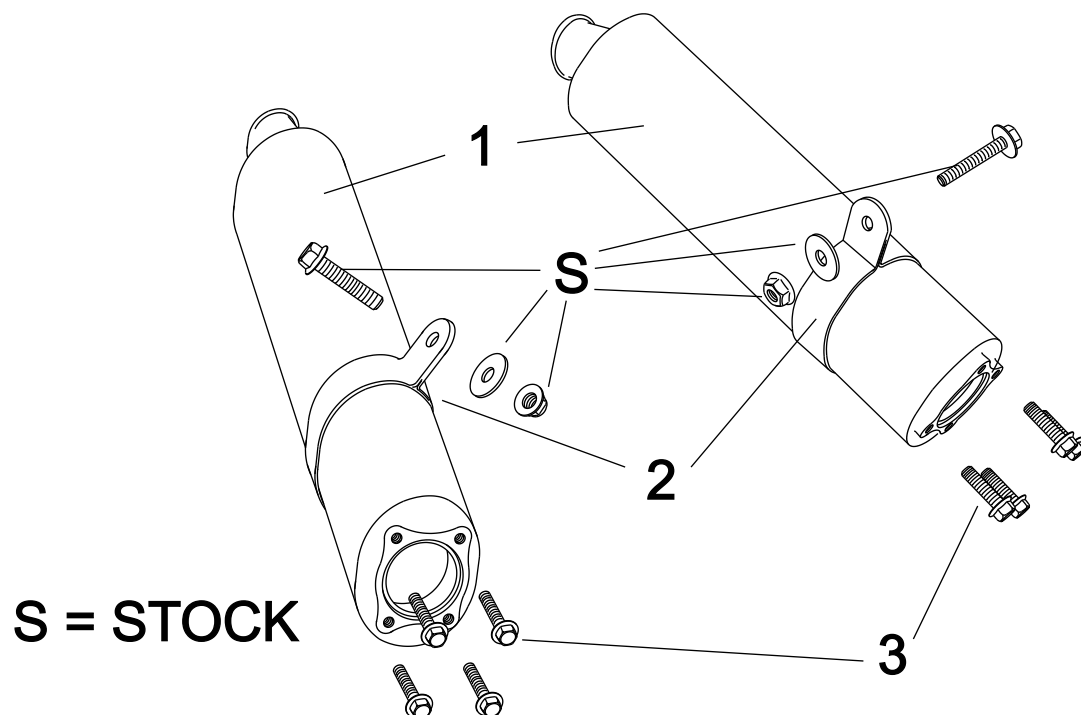

Parts Diagram

| NO. | DESCRIPTION | QTY | PART # |
|-----|-------------------------------|-----|------------|
| 1 | RS-3 Oval Muffler Assembly | 2 | ** |
| 2 | Stainless Steel Muffler Clamp | 2 | CO450S8AOL |
| 3 | 8mm x 20mm Flange Hex Bolt | 8 | M8X20H |
| ** | Muffler Clamp Heat Insulator | 2 | HT SHLD5 |
| ** | Yoshimura Vinyl Sticker | 1 | 17029 |

Nuts and Bolts Guide (Actual Size):

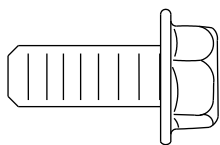

8mm x 20mm
Flange Hex Bolt