



YOSHIMURA

RESEARCH&DEVELOPMENT OF AMERICA, INC.

5420 DANIELS STREET STE A, CHINO CA. 91786 · (800)634-9166 · (909)628-4722 · FACSIMILE (909)591-2198

www.yoshimura-rd.com

RS-3 OVAL PERFORMANCE EXHAUST SYSTEM

HONDA
'99-00
CBR600F4

CB646S0

RACE ONLY STAINLESS STEEL SLIP ON SYSTEM

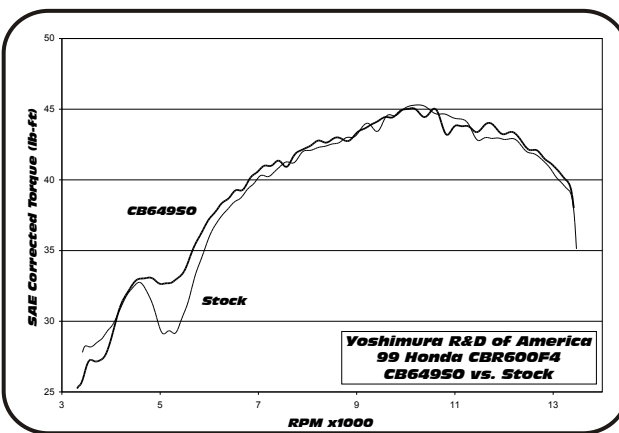
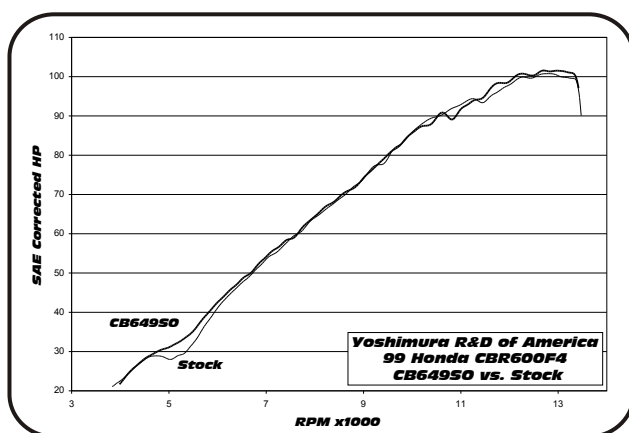

Note: Dyno graphs are for comparison use only. Actual results may vary depending on operating and motorcycle condition.



**THIS PRODUCT IS DESIGNED FOR USE IN CLOSED COURSE
RACING AND IS NOT INTENDED FOR HIGHWAY USE.**



NOTE: IN THE STATE OF CALIFORNIA, IT IS ILLEGAL TO MODIFY THE EMISSION CONTROL SYSTEM, WHICH INCLUDES THE CARBURETORS OF ANY VEHICLE.

Caution: Exhaust system can be extremely hot. Let motorcycle cool down before beginning installation.

Note: Read through all instructions before beginning installation.

Tools Needed:

11mm(7/16") and 12mm sockets
3/8" ratchet
12mm wrench
5mm Allen wrench
Phillips screwdriver
Torque wrench
Power drill
13/64" drill bit
Safety glasses

Installation Steps:

- 1 Remove left and right cowling together.
(See Fig. 1 & 2 for fastener locations)
- 2 Remove stock muffler and tailpipe assembly.
- 3 Slip supplied 2" stainless steel exhaust clamp over end of Yoshimura tailpipe.
- 4 Install Yoshimura Muffler and tailpipe assembly onto stock header.
- 5 Apply muffler clamp heat insulator to inside of muffler clamp and slide clamp onto muffler.
(Note direction of clamp in Fig. 3)
- 6 Mount clamp to stock muffler bracket using stock bolt, washer, and nut. (see Fig. 3)
Hand tighten only at this point.
- 7 Standing at the back of the motorcycle, check the orientation of the muffler (the exhaust tip should be pointing down) and check for clearance between swing arm, rear brake and muffler.
- 8 Tighten muffler clamp bolt to 2.5 kg-m (18 lb-ft).



Fig. 1



Fig. 2

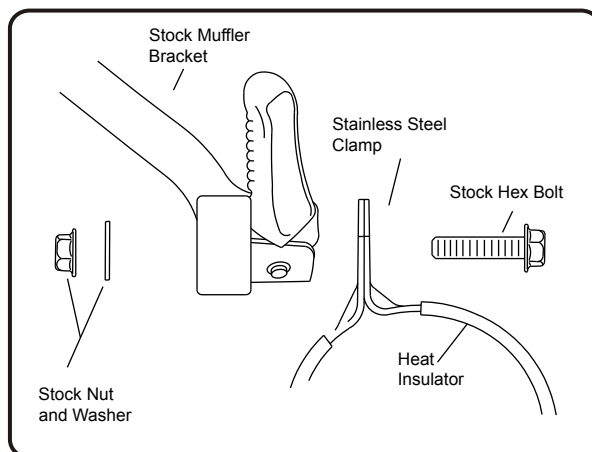

Fig. 3

- 9 Drill 13/64" hole thru end of header at the center of the securing hole in Yoshimura tailpipe. (See Fig.4) (Caution: Always wear eye protection when using any power tool.)
- 10 Install securing rivet into drilled hole, slide 2" stainless steel exhaust clamp over rivet and tighten clamp to 1.25 kg-m (9 lb-ft).
- 11 It is recommended that the muffler and tailpipe be wiped down with rubbing alcohol to remove oil and fingerprints. This will help prevent tarnishing of the finish after the exhaust is heated up.
- 12 Check for proper clearance between new exhaust system and motorcycle. (i.e. radiator, oil pan, swing-arm, etc.) If any problem is found, please carefully follow through the installation steps again. If problem still persists, please call Yoshimura tech. dept. at (800)634-9166 / in CA (909)628-4722
- 13 Reinstall cowlings.
- 14 Check for proper clearance between new exhaust system and cowling.

Note: After starting motorcycle, it is normal for new exhaust system to smoke until oil residue burns off.

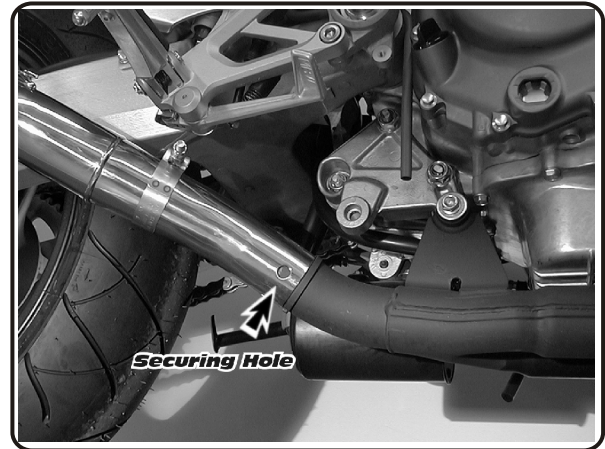
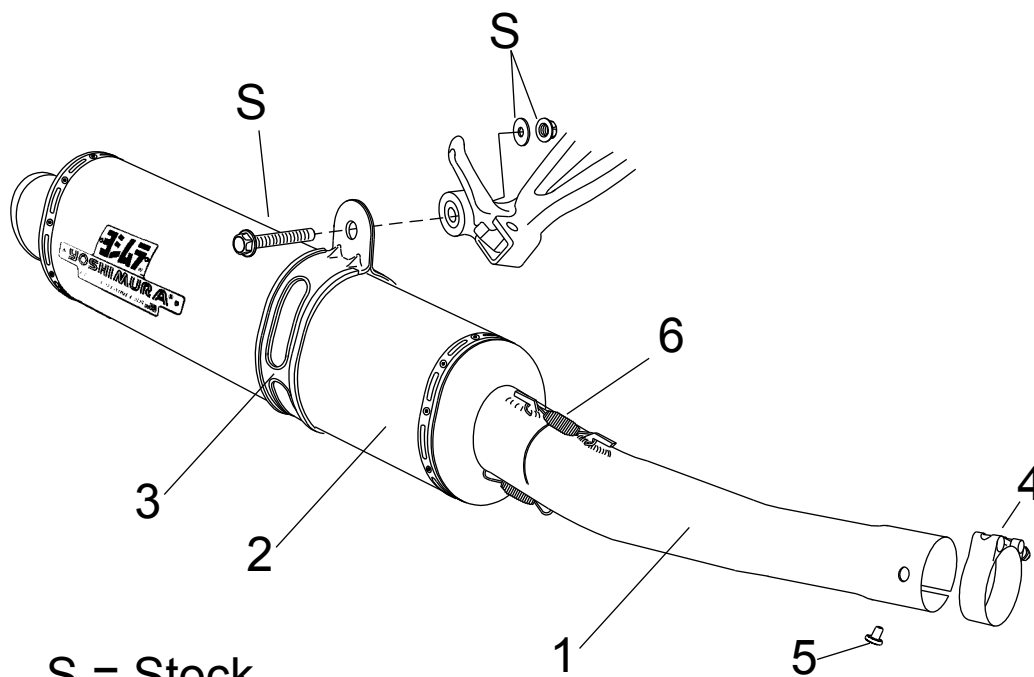

Fig. 4

#CB646S0



Parts Diagram

NO.	DESCRIPTION	QTY	PART #
1	Yoshimura Tailpipe Stainless Steel Tailpipe	1	CB646SOT
2	RS-3 Oval Muffler Assembly	1	**
3	Stainless Steel Muffler Clamp Stainless Steel or Titanium Sleeve uses Carbon Fiber Sleeve uses	1	COS450S8ASX COS450S8AS
4	2" Stainless Steel Exhaust Clamp	1	20060
5	Securing Rivet	1	S-RIVET
6	2.5" Exhaust Spring	2	RACE-SPS
**	Muffler Clamp Heat Insulator	1	HT SHLDTRS
**	Yoshimura Vinyl Sticker	1	17029